

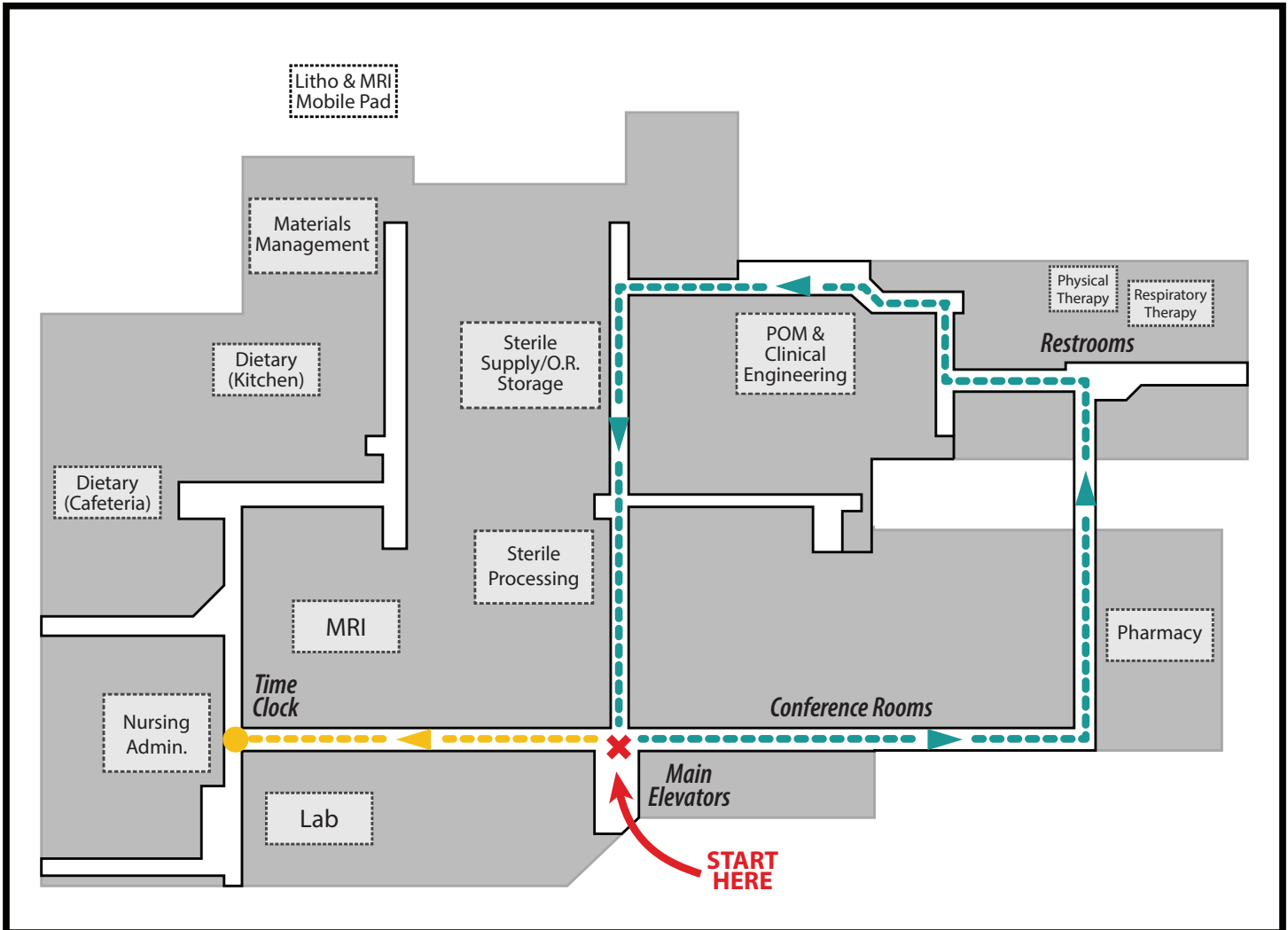

## CHS Pineville Ground Floor Indoor Walking Route



### 1. 7 laps = 1.06 miles Start/Finish on the Ground Floor at the Main Elevators

- Head down the hall past the Conference rooms until you reach the end of the hall
- Turn Left at the end of the hall, walk until you reach the Men/Women Restrooms
- Turn Left, following the exit signs, turning right, then turn left continuing down to the end of that hall.
- At the end of the hall turn left, follow hall back to Main Elevators.

### 2. 6 Laps = .98 mile Start/Finish on the Ground Floor at Tower Elevators "Time Clock"

- Head down the hall past the Main Elevators & Conference rooms until you reach the end of the hall
- Turn Left at the end of the hall, walk until you reach the Men/Women Restrooms
- Turn Left, following the exit signs by turning right, then turn left continuing down to the end of that hall.
- At the end of the hall turn left, follow hall back to Main Elevators
- Before the Main Elevators, turn right in the hall to return to the Time Clock and Tower Elevators.